

SIZE A	DWG NO 65L817TK2	SHT 2	REV
REV	DESCRIPTION	DATE	APPROVED

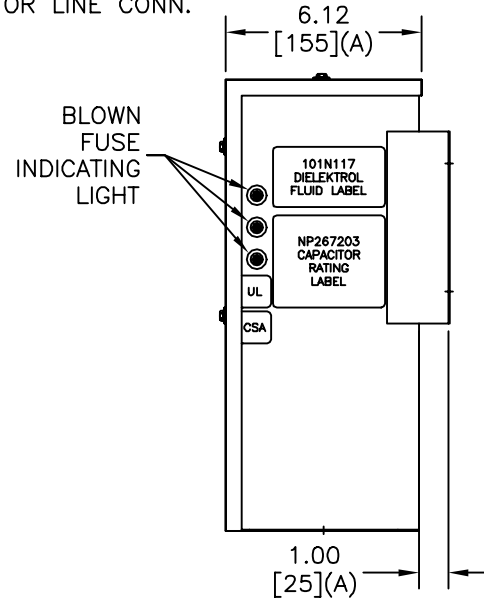
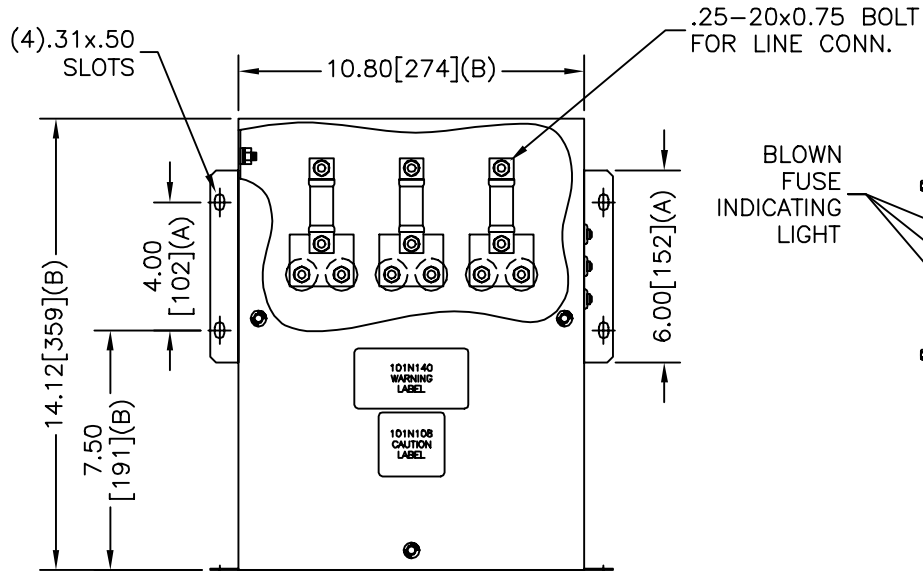
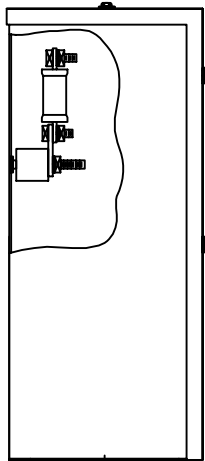
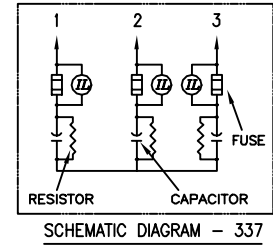
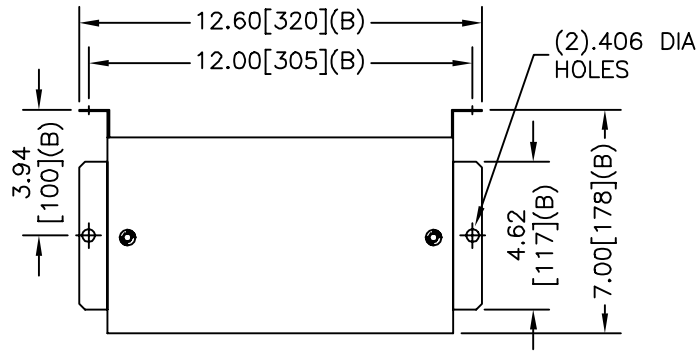

BLOWN FUSE INDICATING LIGHT

GE CAPACITOR

WITH INTERNAL DISCHARGE RESISTORS

CAT 65L817TK2 SN
 30 KVAR 600V 60HZ 3PH

CONTAINS 0.25 GAL. COMBUSTIBLE LIQUID WITH LESS THAN ONE PART PER MILLION PCB ON MFG DATE MM/YYYY
 CAUTION! BEFORE INSTALLING OR OPERATING READ GEH- 2738

NP267203 FORT EDWARD, N.Y. MADE IN U.S.A.

TOL	+/-
A	.06
B	.12
C	.18
D	.25

INDUSTRIAL SYSTEMS FORT EDWARD, N.Y., U.S.A.		SIZE A
DRAWN B.Ross	DATE 5/13/2003	SCALE
ISSUED	DATE 5/14/2003	

OUTLINE
65L817TK2

SHEET 2 CONT ON -

DISTR. TO