

SIZE A	DWG NO 911XPA012AS	SHT 1	REV
REV	DESCRIPTION	DATE	APPROVED

**GE Tranquell®
10.2 kV MCOV**

LINE TERMINAL DETAIL

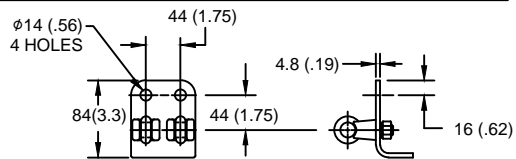

HDG 4-HOLE TERMINAL PAD,
TWO HDG TERMINALS,
SUITABLE FOR Cu OR Al CONDUCTOR SIZE
φ 7 (.25) - φ 21 (.81) DIA
25 - 240 sq mm
AWG#4 - 500 MCM

GROUND TERMINAL DETAIL

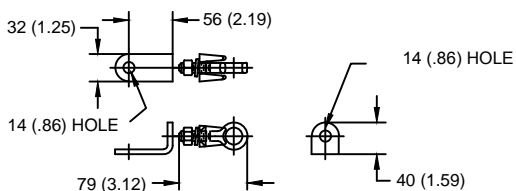

HDG TERMINAL BRACKET
ONE HDG TERMINAL
SUITABLE FOR Cu OR Al CONDUCTOR SIZE
φ 7 (.25) - φ 21 (.81) DIA
25 - 240 sq mm
AWG#4 - 500 MCM

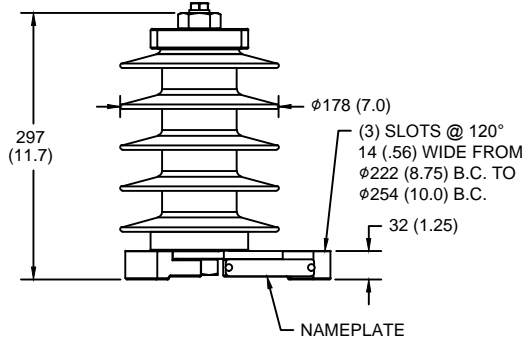

CHARACTERISTICS

RATED VOLTAGE	12 kVrms
MCOV	10.2 kVrms
MASS	6.8 kg (15 lb)
COG ABOVE BASE	150 (5.9)
CREEPAGE DISTANCE	765 (30.1)
STRIKE DISTANCE	221 (8.7)
LIGHTNING IMP W/S	127 kVpk
SWITCHING IMP WET W/S	106 kVpk
POWER FREQ WET W/S	63 kVrms
TOV 1s NO PRIOR DUTY	14.5 kVrms
TOV 10s NO PRIOR DUTY	13.9 kVrms
TOV 1s W/PRIOR DUTY	14 kVrms
TOV 10s W/PRIOR DUTY	13.5 kVrms

CANTILEVER FORCE

MAXIMUM CONTINUOUS	2974 N (669 lbs)
ULTIMATE (max pk)	5947 N (1337 lbs)

RECOMMENDED CLEARANCE (CENTER - CENTER)

PHASE TO GROUND	28.4 (1.1)
PHASE TO PHASE	50.8 (2.0)

NOTES:
1. DIMENSIONS IN millimeters(inches) SUBJECT TO ±3% TOLERANCE
2. CLEARANCE AND INSULATION W/S VOLTAGE APPLY AT SEA LEVEL
3. ARRESTER SUITABLE FOR OPERATION AT ALTITUDES UP TO 4380 m (14370 ft)
4. PACKAGED IN A CORRUGATED BOX.

.5μSEC 10kA IR kV	SWITCHING SURGE IR kV		MAXIMUM 8/20 DISCHARGE VOLTAGE - kV AT					
	500 A	1 KA	1.5 kA	3.0 kA	5 kA	10 kA	20 kA	40 kA
35.1	24.0	25.0	25.6	26.9	28.2	30.3	32.8	37.4

GE ENERGY
FORT EDWARD, N.Y., U.S.A.

SIZE
A
ANSI/IEEE C62.11
STATION CLASS

**ARRESTER
9L11XPA012AS**

DRAWN	DCS	DATE	11/20/2014
ISSUED		DATE	11/20/2014

SCALE		SHEET	1	CONT	ON
-------	--	-------	---	------	----

DISTR. TO