

SIZE A	DWG NO 911XPA015AS	SHT 1	REV
REV	DESCRIPTION	DATE	APPROVED

GE Tranquell® 12.7 kV MCOV

LINE TERMINAL DETAIL

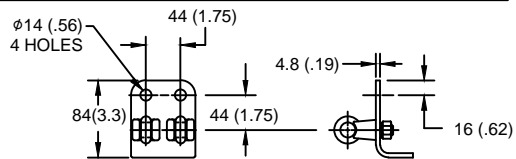

HDG 4-HOLE TERMINAL PAD,
TWO HDG TERMINALS,
SUITABLE FOR Cu OR Al CONDUCTOR SIZE
φ 7 (.25) - φ 21 (.81) DIA
25 - 240 sq mm
AWG#4 - 500 MCM

GROUND TERMINAL DETAIL

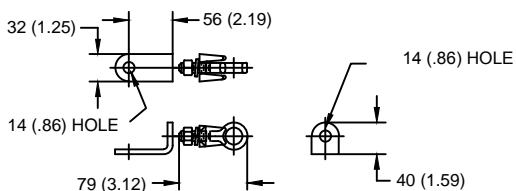

HDG TERMINAL BRACKET
ONE HDG TERMINAL
SUITABLE FOR Cu OR Al CONDUCTOR SIZE
φ 7 (.25) - φ 21 (.81) DIA
25 - 240 sq mm
AWG#4 - 500 MCM

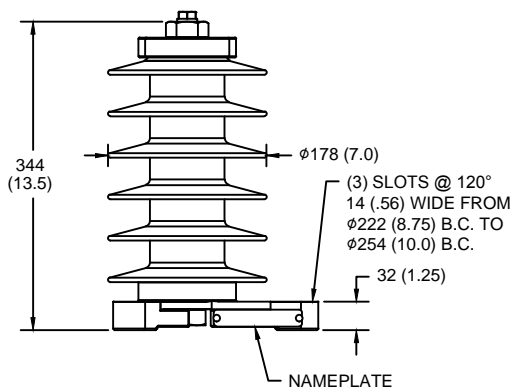

CHARACTERISTICS

RATED VOLTAGE	15 kVrms
MCOV	12.7 kVrms
MASS	7.8 kg (17.3 lb)
COG ABOVE BASE	173 (6.8)
CREEPAGE DISTANCE	898 (35.4)
STRIKE DISTANCE	267 (10.5)
LIGHTNING IMP W/S	153 kVpk
SWITCHING IMP WET W/S	128 kVpk
POWER FREQ WET W/S	75 kVrms
TOV 1s NO PRIOR DUTY	18 kVrms
TOV 10s NO PRIOR DUTY	17.3 kVrms
TOV 1s W/PRIOR DUTY	17.5 kVrms
TOV 10s W/PRIOR DUTY	16.8 kVrms

CANTILEVER FORCE

MAXIMUM CONTINUOUS	2646 N (595 lbs)
ULTIMATE (max pk)	5293 N (1190 lbs)

RECOMMENDED CLEARANCE (CENTER - CENTER)

PHASE TO GROUND	47.7 (1.9)
PHASE TO PHASE	71.0 (2.8)

NOTES:
1. DIMENSIONS IN millimeters(inches) SUBJECT TO ±3% TOLERANCE
2. CLEARANCE AND INSULATION W/S VOLTAGE APPLY AT SEA LEVEL
3. ARRESTER SUITABLE FOR OPERATION AT ALTITUDES UP TO 4380 m (14370 ft)
4. PACKAGED IN A CORRUGATED BOX.

.5μSEC 10kA IR kV	SWITCHING SURGE IR kV		MAXIMUM 8/20 DISCHARGE VOLTAGE - kV AT					
	500 A	1 KA	1.5 kA	3.0 kA	5 kA	10 kA	20 kA	40 kA
43.4	29.9	31.2	31.9	33.5	35.2	37.7	40.8	46.5

GE ENERGY
FORT EDWARD, N.Y., U.S.A.

DRAWN: DCS DATE: 11/20/2014

ISSUED: DATE: 11/20/2014

SIZE: **A**

ANSI/IEEE C62.11
STATION CLASS

SCALE:

ARRESTER 9L11XPA015AS

SHEET 1 CONT ON -

DISTR. TO