

SIZE A	DWG NO 911XPA018AS	SHT 1	REV
REV	DESCRIPTION	DATE	APPROVED

**GE Tranquell®
15.3 kV MCOV**

LINE TERMINAL DETAIL

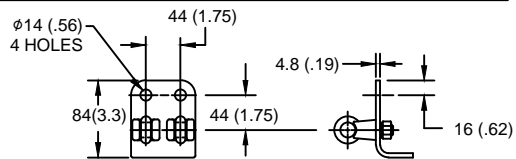

HDG 4-HOLE TERMINAL PAD,
TWO HDG TERMINALS,
SUITABLE FOR Cu OR Al CONDUCTOR SIZE
φ 7 (.25) - φ 21 (.81) DIA
25 - 240 sq mm
AWG#4 - 500 MCM

GROUND TERMINAL DETAIL

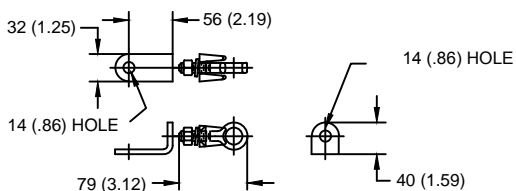

HDG TERMINAL BRACKET
ONE HDG TERMINAL
SUITABLE FOR Cu OR Al CONDUCTOR SIZE
φ 7 (.25) - φ 21 (.81) DIA
25 - 240 sq mm
AWG#4 - 500 MCM

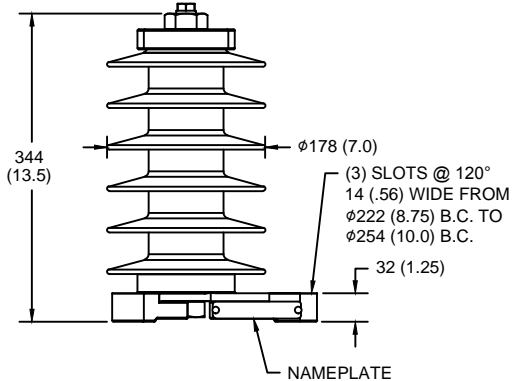

CHARACTERISTICS

RATED VOLTAGE	18 kVrms
MCOV	15.3 kVrms
MASS	7.8 kg (17.3 lb)
COG ABOVE BASE	173 (6.8)
CREEPAGE DISTANCE	898 (35.4)
STRIKE DISTANCE	267 (10.5)
LIGHTNING IMP W/S	153 kVpk
SWITCHING IMP WET W/S	128 kVpk
POWER FREQ WET W/S	75 kVrms
TOV 1s NO PRIOR DUTY	21.7 kVrms
TOV 10s NO PRIOR DUTY	20.8 kVrms
TOV 1s W/PRIOR DUTY	21 kVrms
TOV 10s W/PRIOR DUTY	20.2 kVrms

CANTILEVER FORCE

MAXIMUM CONTINUOUS	2646 N (595 lbs)
ULTIMATE (max pk)	5293 N (1190 lbs)

RECOMMENDED CLEARANCE (CENTER - CENTER)

PHASE TO GROUND	67.7 (2.7)
PHASE TO PHASE	93.7 (3.7)

NOTES:
1. DIMENSIONS IN millimeters(inches) SUBJECT TO ±3% TOLERANCE
2. CLEARANCE AND INSULATION W/S VOLTAGE APPLY AT SEA LEVEL
3. ARRESTER SUITABLE FOR OPERATION AT ALTITUDES UP TO 4380 m (14370 ft)
4. PACKAGED IN A CORRUGATED BOX.

.5μ SEC 10kA IR kV	SWITCHING SURGE IR kV		MAXIMUM 8/20 DISCHARGE VOLTAGE - kV AT					
	500 A	1 KA	1.5 kA	3.0 kA	5 kA	10 kA	20 kA	40 kA
51.6	36.1	37.6	38.5	40.4	42.4	45.5	49.1	56.1

GE ENERGY
FORT EDWARD, N.Y., U.S.A.

SIZE
A
ANSI/IEEE C62.11
STATION CLASS

**ARRESTER
9L11XPA018AS**

DRAWN	DCS	DATE	11/20/2014
ISSUED		DATE	11/20/2014

SCALE		SHEET	1	CONT	ON
-------	--	-------	---	------	----

DISTR. TO