

SIZE A	DWG NO 911XPA021AS	SHT 1	REV
REV	DESCRIPTION	DATE	APPROVED

**GE Tranquell®
17 kV MCOV**

LINE TERMINAL DETAIL

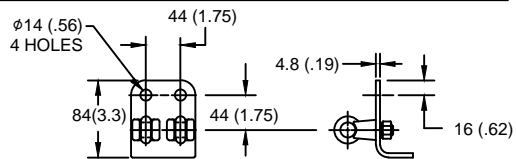

HDG 4-HOLE TERMINAL PAD,
TWO HDG TERMINALS,
SUITABLE FOR Cu OR Al CONDUCTOR SIZE
φ 7 (.25) - φ 21 (.81) DIA
25 - 240 sq mm
AWG#4 - 500 MCM

GROUND TERMINAL DETAIL

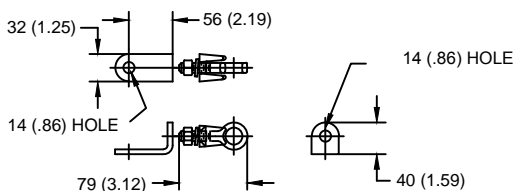

HDG TERMINAL BRACKET
ONE HDG TERMINAL
SUITABLE FOR Cu OR Al CONDUCTOR SIZE
φ 7 (.25) - φ 21 (.81) DIA
25 - 240 sq mm
AWG#4 - 500 MCM

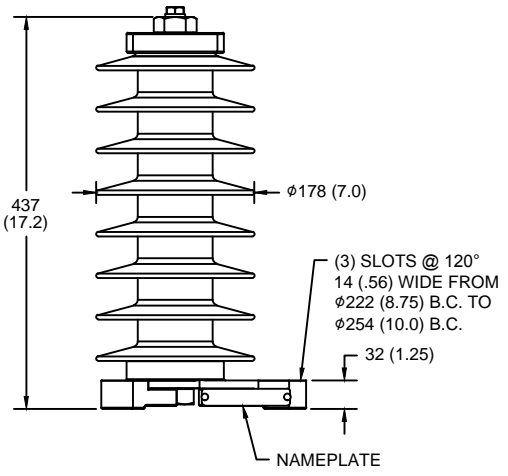

CHARACTERISTICS

RATED VOLTAGE	21 kVrms
MCOV	17 kVrms
MASS	9.9 kg (21.9 lb)
COG ABOVE BASE	218 (8.6)
CREEPAGE DISTANCE	1029 (40.5)
STRIKE DISTANCE	361 (14.2)
LIGHTNING IMP W/S	207 kVpk
SWITCHING IMP WET W/S	173 kVpk
POWER FREQ WET W/S	101 kVrms
TOV 1s NO PRIOR DUTY	24.2 kVrms
TOV 10s NO PRIOR DUTY	23.1 kVrms
TOV 1s W/PRIOR DUTY	23.4 kVrms
TOV 10s W/PRIOR DUTY	22.4 kVrms

CANTILEVER FORCE

MAXIMUM CONTINUOUS	2173 N (489 lbs)
ULTIMATE (max pk)	4346 N (977 lbs)

RECOMMENDED CLEARANCE (CENTER - CENTER)

PHASE TO GROUND	80.9 (3.2)
PHASE TO PHASE	108.5 (4.3)

NOTES:
1. DIMENSIONS IN millimeters(inches) SUBJECT TO ±3% TOLERANCE
2. CLEARANCE AND INSULATION W/S VOLTAGE APPLY AT SEA LEVEL
3. ARRESTER SUITABLE FOR OPERATION AT ALTITUDES UP TO 4380 m (14370 ft)
4. PACKAGED IN A CORRUGATED BOX.

.5μSEC 10kA IR kV	SWITCHING SURGE IR kV		MAXIMUM 8/20 DISCHARGE VOLTAGE - kV AT					
	500 A	1 KA	1.5 kA	3.0 kA	5 kA	10 kA	20 kA	40 kA
57.8	40.1	41.7	42.7	44.9	47.1	50.5	54.6	62.3

GE ENERGY
FORT EDWARD, N.Y., U.S.A.

SIZE
A
ANSI/IEEE C62.11
STATION CLASS

**ARRESTER
9L11XPA021AS**

DRAWN	DCS	DATE	11/20/2014
ISSUED		DATE	11/20/2014

SCALE		SHEET	1	CONT	ON
-------	--	-------	---	------	----

DISTR. TO