

SIZE A	DWG NO 911XPA048AS	SHT 1	REV
REV	DESCRIPTION	DATE	APPROVED

**GE Tranquell®  
39 kV MCOV**

**LINE TERMINAL DETAIL**

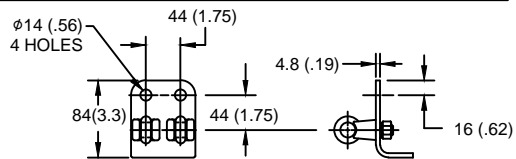

HDG 4-HOLE TERMINAL PAD,  
TWO HDG TERMINALS,  
SUITABLE FOR Cu OR Al CONDUCTOR SIZE  
φ 7 (.25) - φ 21 (.81) DIA  
25 - 240 sq mm  
AWG#4 - 500 MCM

**GROUND TERMINAL DETAIL**

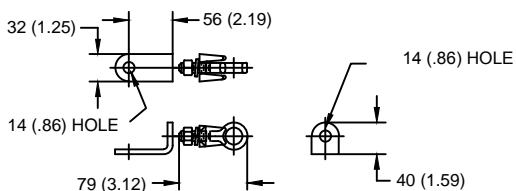

HDG TERMINAL BRACKET  
ONE HDG TERMINAL  
SUITABLE FOR Cu OR Al CONDUCTOR SIZE  
φ 7 (.25) - φ 21 (.81) DIA  
25 - 240 sq mm  
AWG#4 - 500 MCM

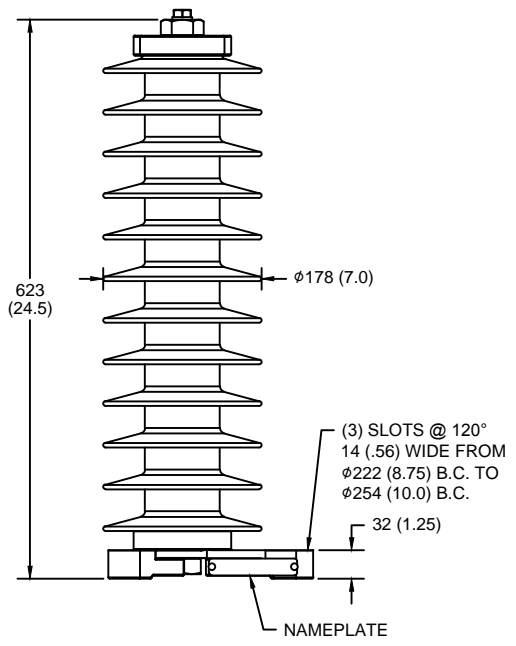

**CHARACTERISTICS**

RATED VOLTAGE	48 kVrms
MCOV	39 kVrms
MASS	14.2 kg (31.2 lb)
COG ABOVE BASE	312 (12.3)
CREEPAGE DISTANCE	1562 (61.5)
STRIKE DISTANCE	546 (21.5)
LIGHTNING IMP W/S	313 kVpk
SWITCHING IMP WET W/S	263 kVpk
POWER FREQ WET W/S	148 kVrms
TOV 1s NO PRIOR DUTY	55.4 kVrms
TOV 10s NO PRIOR DUTY	53 kVrms
TOV 1s W/PRIOR DUTY	53.6 kVrms
TOV 10s W/PRIOR DUTY	51.5 kVrms

**CANTILEVER FORCE**

MAXIMUM CONTINUOUS	1601 N (360 lbs)
ULTIMATE (max pk)	3201 N (720 lbs)

**RECOMMENDED CLEARANCE (CENTER - CENTER)**

PHASE TO GROUND	250.7 (9.9)
PHASE TO PHASE	300.5 (11.8)

NOTES:  
1. DIMENSIONS IN millimeters(inches) SUBJECT TO ±3% TOLERANCE  
2. CLEARANCE AND INSULATION W/S VOLTAGE APPLY AT SEA LEVEL  
3. ARRESTER SUITABLE FOR OPERATION AT ALTITUDES UP TO 4380 m (14370 ft)  
4. PACKAGED IN A CORRUGATED BOX.

.5μSEC 10kA IR kV	SWITCHING SURGE IR kV		MAXIMUM 8/20 DISCHARGE VOLTAGE - kV AT					
	500 A	1 KA	1.5 kA	3.0 kA	5 kA	10 kA	20 kA	40 kA
129	91.9	95.7	98.0	103	108	116	125	143

**GE ENERGY**  
FORT EDWARD, N.Y., U.S.A.

DRAWN **DCS**      DATE **11/20/2014**

ISSUED      DATE **11/20/2014**

SIZE  
**A**

ANSI/IEEE C62.11  
STATION CLASS

SCALE

**ARRESTER  
9L11XPA048AS**

SHEET **1**      CONT ON **-**

DISTR. TO