

SIZE A	DWG NO 911XPA060AS	SHT 1	REV
REV	DESCRIPTION	DATE	APPROVED

# GE Tranquell® 48 kV MCOV

### LINE TERMINAL DETAIL

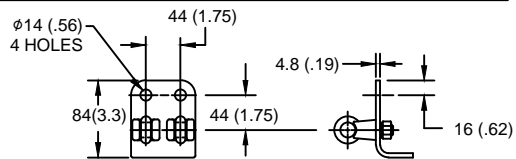

HDG 4-HOLE TERMINAL PAD,  
TWO HDG TERMINALS,  
SUITABLE FOR Cu OR Al CONDUCTOR SIZE  
φ 7 (.25) - φ 21 (.81) DIA  
25 - 240 sq mm  
AWG#4 - 500 MCM

### GROUND TERMINAL DETAIL

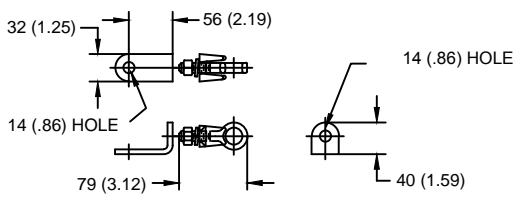

HDG TERMINAL BRACKET  
ONE HDG TERMINAL  
SUITABLE FOR Cu OR Al CONDUCTOR SIZE  
φ 7 (.25) - φ 21 (.81) DIA  
25 - 240 sq mm  
AWG#4 - 500 MCM

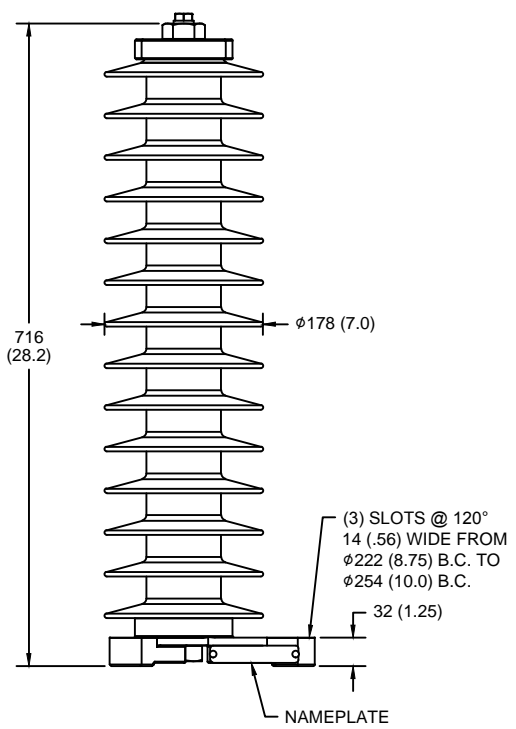

CHARACTERISTICS	
RATED VOLTAGE	60 kVrms
MCOV	48 kVrms
MASS	16.3 kg (35.9 lb)
COG ABOVE BASE	358 (14.1)
CREEPAGE DISTANCE	1827 (71.9)
STRIKE DISTANCE	640 (25.2)
LIGHTNING IMP W/S	367 kVpk
SWITCHING IMP WET W/S	308 kVpk
POWER FREQ WET W/S	172 kVrms
TOV 1s NO PRIOR DUTY	69 kVrms
TOV 10s NO PRIOR DUTY	66 kVrms
TOV 1s W/PRIOR DUTY	66.7 kVrms
TOV 10s W/PRIOR DUTY	64.1 kVrms

CANTILEVER FORCE	
MAXIMUM CONTINUOUS	1414 N (318 lbs)
ULTIMATE (max pk)	2829 N (636 lbs)

RECOMMENDED CLEARANCE (CENTER - CENTER)	
PHASE TO GROUND	324.3 (12.8)
PHASE TO PHASE	383.7 (15.1)

.5μSEC 10kA IR kV	SWITCHING SURGE IR kV		MAXIMUM 8/20 DISCHARGE VOLTAGE - kV AT					
	500 A	1 KA	1.5 kA	3.0 kA	5 kA	10 kA	20 kA	40 kA
160	114	119	122	128	134	144	156	178

NOTES:  
1. DIMENSIONS IN millimeters(inches) SUBJECT TO ±3% TOLERANCE  
2. CLEARANCE AND INSULATION W/S VOLTAGE APPLY AT SEA LEVEL  
3. ARRESTER SUITABLE FOR OPERATION AT ALTITUDES UP TO 4380 m (14370 ft)  
4. PACKAGED IN A CORRUGATED BOX.

**GE ENERGY**  
FORT EDWARD, N.Y., U.S.A.

DRAWN **DCS**      DATE **11/20/2014**

ISSUED                      DATE **11/20/2014**

SIZE  
**A**

ANSI/IEEE C62.11  
STATION CLASS

SCALE

# ARRESTER 9L11XPA060AS

SHEET **1**      CONT ON **-**

DISTR. TO