

SIZE A	DWG NO 911XPA072AS	SHT 1	REV
REV	DESCRIPTION	DATE	APPROVED

**GE Tranquell®  
57 kV MCOV**

**LINE TERMINAL DETAIL**

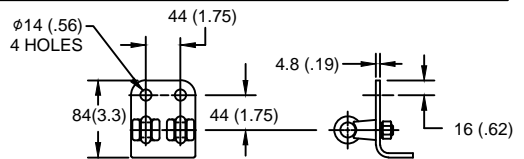

HDG 4-HOLE TERMINAL PAD,  
TWO HDG TERMINALS,  
SUITABLE FOR Cu OR Al CONDUCTOR SIZE  
φ 7 (.25) - φ 21 (.81) DIA  
25 - 240 sq mm  
AWG#4 - 500 MCM

**GROUND TERMINAL DETAIL**

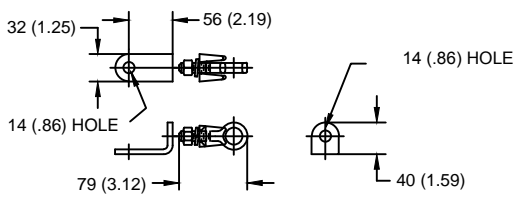

HDG TERMINAL BRACKET  
ONE HDG TERMINAL  
SUITABLE FOR Cu OR Al CONDUCTOR SIZE  
φ 7 (.25) - φ 21 (.81) DIA  
25 - 240 sq mm  
AWG#4 - 500 MCM

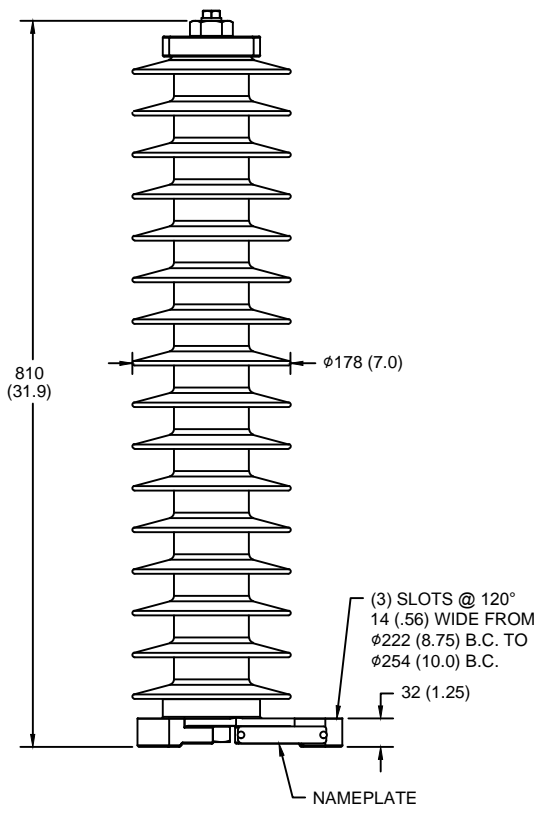

**CHARACTERISTICS**

RATED VOLTAGE	72 kVrms
MCOV	57 kVrms
MASS	18.6 kg (41.1 lb)
COG ABOVE BASE	406 (16)
CREEPAGE DISTANCE	2093 (82.4)
STRIKE DISTANCE	734 (28.9)
LIGHTNING IMP W/S	421 kVpk
SWITCHING IMP WET W/S	353 kVpk
POWER FREQ WET W/S	194 kVrms
TOV 1s NO PRIOR DUTY	82.8 kVrms
TOV 10s NO PRIOR DUTY	79.3 kVrms
TOV 1s W/PRIOR DUTY	80.2 kVrms
TOV 10s W/PRIOR DUTY	77 kVrms

**CANTILEVER FORCE**

MAXIMUM CONTINUOUS	1265 N (284 lbs)
ULTIMATE (max pk)	2531 N (569 lbs)

**RECOMMENDED CLEARANCE (CENTER - CENTER)**

PHASE TO GROUND	399.7 (15.7)
PHASE TO PHASE	468.9 (18.5)

NOTES:  
1. DIMENSIONS IN millimeters(inches) SUBJECT TO ±3% TOLERANCE  
2. CLEARANCE AND INSULATION W/S VOLTAGE APPLY AT SEA LEVEL  
3. ARRESTER SUITABLE FOR OPERATION AT ALTITUDES UP TO 4380 m (14370 ft)  
4. PACKAGED IN A CORRUGATED BOX.

.5μSEC 10kA IR kV	SWITCHING SURGE IR kV		MAXIMUM 8/20 DISCHARGE VOLTAGE - kV AT					
	500 A	1 KA	1.5 kA	3.0 kA	5 kA	10 kA	20 kA	40 kA
192	137	143	147	154	161	173	187	214

**GE ENERGY**  
FORT EDWARD, N.Y., U.S.A.

SIZE  
**A**  
ANSI/IEEE C62.11  
STATION CLASS

**ARRESTER  
9L11XPA072AS**

DRAWN	DCS	DATE	11/20/2014
ISSUED		DATE	11/20/2014

SCALE		SHEET	1	CONT	ON
-------	--	-------	---	------	----

DISTR. TO