

SIZE A	DWG NO 911XPA120AS	SHT 1	REV
REV	DESCRIPTION	DATE	APPROVED

GE Tranquell® 98 kV MCOV

LINE TERMINAL DETAIL

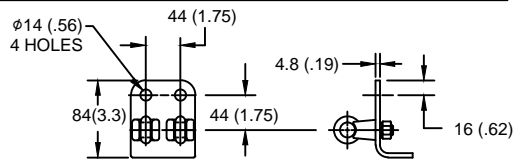

HDG 4-HOLE TERMINAL PAD,
TWO HDG TERMINALS,
SUITABLE FOR Cu OR Al CONDUCTOR SIZE
φ 7 (.25) - φ 21 (.81) DIA
25 - 240 sq mm
AWG#4 - 500 MCM

GROUND TERMINAL DETAIL

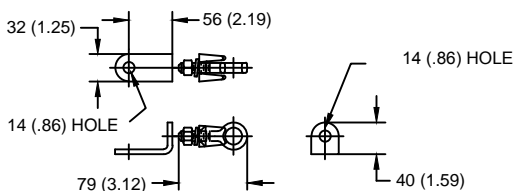

HDG TERMINAL BRACKET
ONE HDG TERMINAL
SUITABLE FOR Cu OR Al CONDUCTOR SIZE
φ 7 (.25) - φ 21 (.81) DIA
25 - 240 sq mm
AWG#4 - 500 MCM

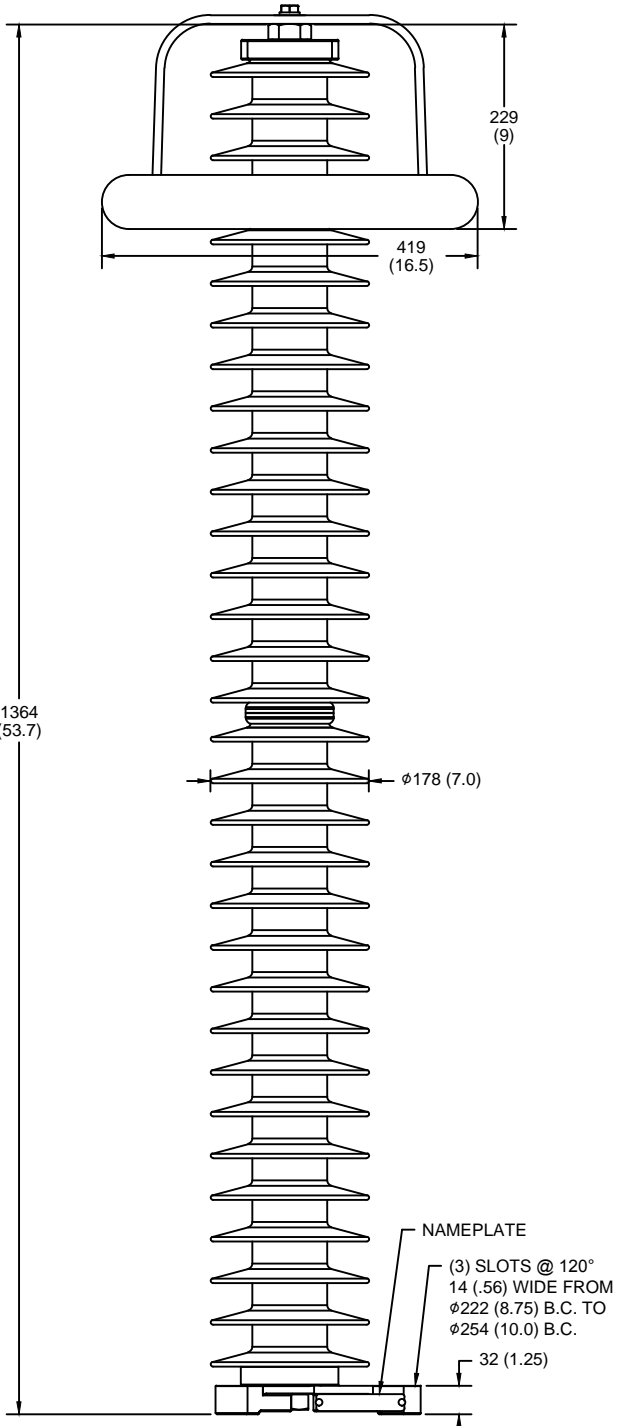

CHARACTERISTICS	
RATED VOLTAGE	120 kVrms
MCOV	98 kVrms
MASS	33.2 kg (73.1 lb)
COG ABOVE BASE	713 (28.1)
CREEPAGE DISTANCE	3654 (143.9)
STRIKE DISTANCE	1135 (44.7)
LIGHTNING IMP W/S	652 kVpk
SWITCHING IMP WET W/S	546 kVpk
POWER FREQ WET W/S	283 kVrms
TOV 1s NO PRIOR DUTY	139 kVrms
TOV 10s NO PRIOR DUTY	133 kVrms
TOV 1s W/PRIOR DUTY	135 kVrms
TOV 10s W/PRIOR DUTY	129 kVrms

CANTILEVER FORCE	
MAXIMUM CONTINUOUS	781 N (176 lbs)
ULTIMATE (max pk)	1562 N (351 lbs)

RECOMMENDED CLEARANCE (CENTER - CENTER)	
PHASE TO GROUND	706.1 (27.8)
PHASE TO PHASE	815.3 (32.1)

.5μSEC 10kA IR kV	SWITCHING SURGE IR kV		MAXIMUM 8/20 DISCHARGE VOLTAGE - kV AT					
	500 A	1 KA	1.5 kA	3.0 kA	5 kA	10 kA	20 kA	40 kA
322	231	241	246	259	271	291	315	359

- NOTES:
1. DIMENSIONS IN millimeters(inches) SUBJECT TO ±3% TOLERANCE
 2. CLEARANCE AND INSULATION W/S VOLTAGE APPLY AT SEA LEVEL
 3. ARRESTER SUITABLE FOR OPERATION AT ALTITUDES UP TO 4380 m (14370 ft)
 4. PACKAGED IN A CORRUGATED BOX.



GE ENERGY
FORT EDWARD, N.Y., U.S.A.

SIZE
A

ANSI/IEEE C62.11
STATION CLASS

ARRESTER 9L11XPA120AS

DRAWN	DCS	DATE	11/20/2014
ISSUED		DATE	11/20/2014

SCALE		SHEET	1	CONT	ON
-------	--	-------	---	------	----

DISTR. TO