

SIZE A	DWG NO 911XPA192AS	SHT 1	REV
REV	DESCRIPTION	DATE	APPROVED

GE Tranquell® 152 kV MCOV

LINE TERMINAL DETAIL

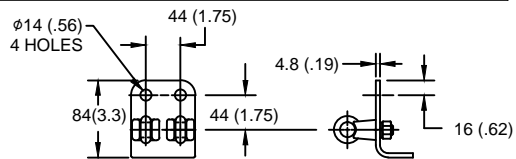

HDG 4-HOLE TERMINAL PAD,
TWO HDG TERMINALS,
SUITABLE FOR Cu OR Al CONDUCTOR SIZE
φ 7 (.25) - φ 21 (.81) DIA
25 - 240 sq mm
AWG#4 - 500 MCM

GROUND TERMINAL DETAIL

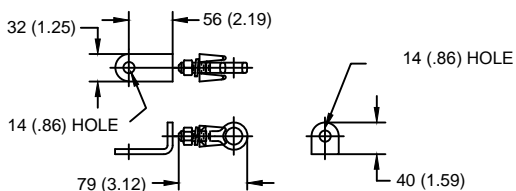

HDG TERMINAL BRACKET
ONE HDG TERMINAL
SUITABLE FOR Cu OR Al CONDUCTOR SIZE
φ 7 (.25) - φ 21 (.81) DIA
25 - 240 sq mm
AWG#4 - 500 MCM

CHARACTERISTICS	
RATED VOLTAGE	192 kVrms
MCOV	152 kVrms
MASS	54.6 kg (120 lb)
COG ABOVE BASE	1139 (44.8)
CREEPAGE DISTANCE	5482 (215.8)
STRIKE DISTANCE	1753 (69)
LIGHTNING IMP W/S	1006 kVpk
SWITCHING IMP WET W/S	843 kVpk
POWER FREQ WET W/S	395 kVrms
TOV 1s NO PRIOR DUTY	221 kVrms
TOV 10s NO PRIOR DUTY	211 kVrms
TOV 1s W/PRIOR DUTY	214 kVrms
TOV 10s W/PRIOR DUTY	205 kVrms

CANTILEVER FORCE	
MAXIMUM CONTINUOUS	256 N (58 lbs)
ULTIMATE (max pk)	1025 N (230 lbs)

RECOMMENDED CLEARANCE (CENTER - CENTER)	
PHASE TO GROUND	1671 (65.8)
PHASE TO PHASE	2024 (79.69)

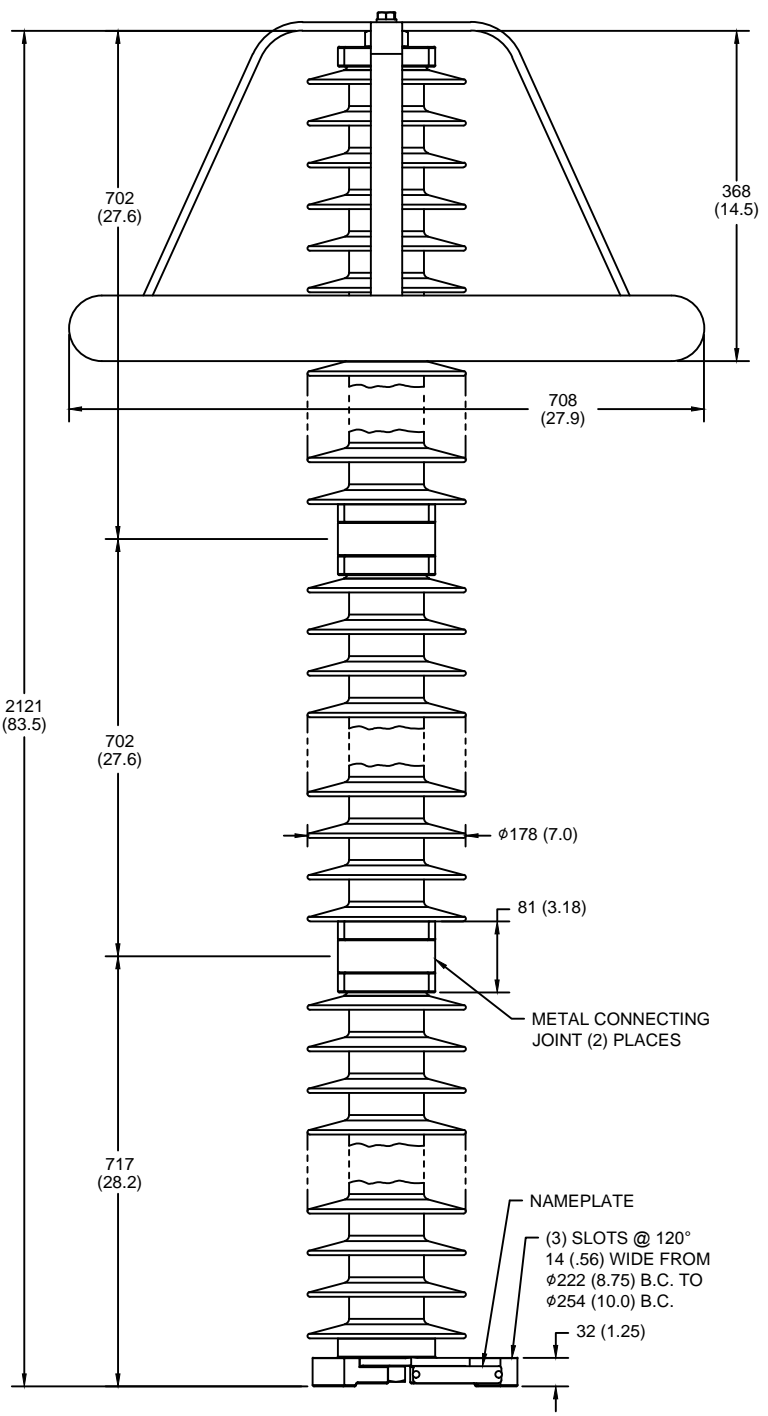

- NOTES:
1. DIMENSIONS IN millimeters(inches) SUBJECT TO ±3% TOLERANCE
2. CLEARANCE AND INSULATION W/S VOLTAGE APPLY AT SEA LEVEL
3. ARRESTER SUITABLE FOR OPERATION AT ALTITUDES UP TO 4380 m (14370 ft)
4. PACKAGED IN A WOOD CRATE.

.5μSEC 10kA IR kV	SWITCHING SURGE IR kV		MAXIMUM 8/20 DISCHARGE VOLTAGE - kV AT					
	500 A	1 KA	1.5 kA	3.0 kA	5 kA	10 kA	20 kA	40 kA
510	366	381	391	411	430	462	499	569

GE ENERGY FORT EDWARD, N.Y., U.S.A.	SIZE A	ANSI/IEEE C62.11 STATION CLASS	ARRESTER 9L11XPA192AS	DISTR. TO
	DRAWN DCS DATE 9/15/2014	SCALE		
ISSUED	DATE 9/15/2014			