

6.9 kV MCOV

SIZE A	DWG NO 911XPE008AS	SHT 1	REV
REV	DESCRIPTION	DATE	APPROVED

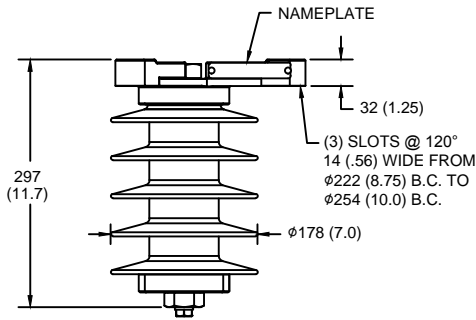

LINE TERMINAL DETAIL

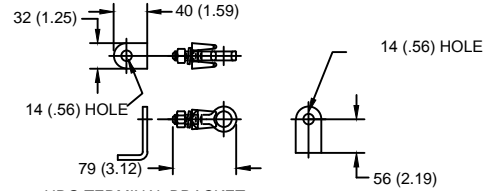

HDG TERMINAL BRACKET
ONE HDG TERMINAL
SUITABLE FOR CU OR AL CONDUCTOR SIZE
Ø 7 (.25) - Ø 21 (.81) DIA
25 - 240 sq mm
AWG#4 - 500 MCM

GROUND TERMINAL DETAIL

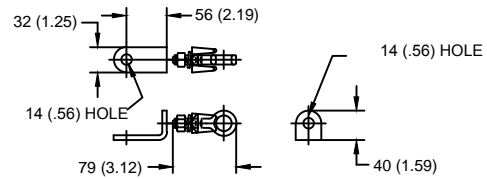

HDG TERMINAL BRACKET
ONE HDG TERMINAL
SUITABLE FOR CU OR AL CONDUCTOR SIZE
Ø 7 (.25) - Ø 21 (.81) DIA
25 - 240 sq mm
AWG#4 - 500 MCM

CHARACTERISTICS	
RATED VOLTAGE (Ur)	8.5 kVrms
MCOV (Uc)	6.9 kVrms
MASS	6.8 kg (15 lb)
COG ABOVE BASE	150 (5.9)
CREEPAGE DISTANCE	765 (30.1)
STRIKE DISTANCE	221 (8.7)
LIGHTNING IMP W/S	127 kVpk
SWITCHING IMP WET W/S	106 kVpk
POWER FREQ WET W/S	63 kVrms
TOV 1s NO PRIOR DUTY	10.9 kVrms
TOV 10s NO PRIOR DUTY	10.4 kVrms
TOV 1s W/PRIOR DUTY	10.5 kVrms
TOV 10s W/PRIOR DUTY	10.1 kVrms

CANTILEVER FORCE	
MAXIMUM CONTINUOUS	2974 N (669 lbs)
ULTIMATE (max pk)	5947 N (1337 lbs)

RECOMMENDED CLEARANCE (METAL - METAL)	
PHASE TO GROUND	25.4 (1)
PHASE TO PHASE	50.8 (2)

- NOTES:
1. DIMENSIONS IN millimeters(inches) SUBJECT TO ±3% TOLERANCE
2. CLEARANCE AND INSULATION W/S VOLTAGE APPLY AT SEA LEVEL
3. ARRESTER SUITABLE FOR OPERATION AT ALTITUDES UP TO 4380 m (14370 ft)
4. PACKAGED IN A CORRUGATED BOX.

.5µSEC 10kA IR kV	SWITCHING SURGE IR kV		MAXIMUM 8/20 DISCHARGE VOLTAGE - kV AT					
	500 A	1 KA	1.5 kA	3.0 kA	5 kA	10 kA	20 kA	40 kA
27.0	18.0	18.8	19.2	20.2	21.2	22.7	24.6	28.0

GE ENERGY FORT EDWARD, N.Y., U.S.A.	SIZE A	ANSI STATION CLASS	ARRESTER 9L11XPE008AS		
	DRAWN JBC	DATE 10/9/2013	SCALE	SHEET 1	CONT ON -
ISSUED	DATE 10/9/2013				

DISTR. TO