

LINE TERMINAL DETAIL

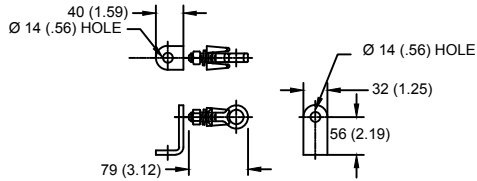

HDG TERMINAL BRACKET, PART No. 896064001
 ONE HDG TERMINAL, PART No. 2714143001
 SUITABLE FOR COPPER OR ALUMINUM CONDUCTOR SIZE
 Ø 7 (.25) - Ø 21 (.81)
 25 - 240 sq mm
 AWG#4 - 500 MCM

GROUND TERMINAL DETAIL

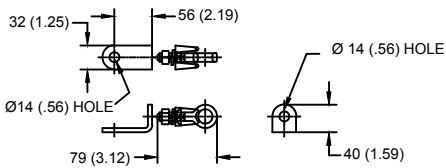

HDG TERMINAL BRACKET, PART No. 896064001
 ONE HDG TERMINAL, PART No. 2714143001
 SUITABLE FOR COPPER OR ALUMINUM CONDUCTOR SIZE
 Ø 7 (.25) - Ø 21 (.81)
 25 - 240 sq mm
 AWG#4 - 500 MCM

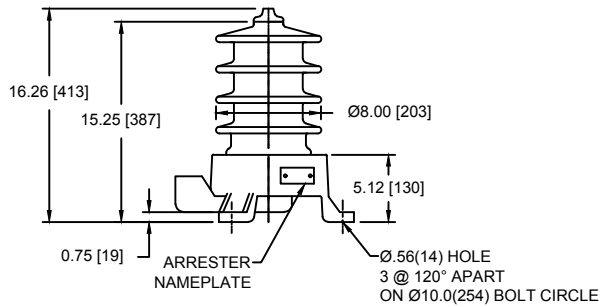

Ø = DIAMETER
 HDG = HOT DIP GALVANIZED

| CHARACTERISTICS | |
|--|-------------------|
| RATED VOLTAGE | 18 kVrms |
| MCOV | 15.3 kVrms |
| MASS | 24kg (54lb) |
| CREEPAGE DISTANCE | 508 (20.0) |
| LIGHTNING IMP W/S | 150 kV |
| SWITCHING IMP W/S | 120 kV |
| POWER FREQ W/S | 60 kVrms |
| TOV 1s | 22.5 kVrms |
| TOV 10s | 21.6 kVrms |
| COG ABOVE BASE | 215 (8.5) |
| HOUSING | GREY PORCELAIN |
| CANTILEVER FORCE | |
| MAXIMUM CONTINUOUS | 7666 N (1723lbf) |
| ULTIMATE (UMS) | 19164 N (4308lbf) |
| RECOMMENDED CLEARANCE (TO METAL PARTS) | |
| PHASE TO GROUND | 58 (2.3) |
| PHASE TO PHASE | 53 (2.1) |

- NOTES:
 1. DIMENSIONS IN millimeters(inches) SUBJECT TO ±3% TOLERANCE
 2. CLEARANCE AND INSULATION W/S VOLTAGE APPLY AT SEA LEVEL
 3. ARRESTER SUITABLE FOR OPERATION AT ALTITUDES UP TO 4500m (14800ft)

| DISCHARGE VOLTAGE (kV) FOR INDICATED IMPULSE TYPES AND CURRENT MAGNITUDES | | | | | | | | | |
|---|-----------------|------------------------|--------|------|--------|------|------|-------|-------|
| FRONT OF WAVE | SWITCHING SURGE | 8/20 LIGHTNING IMPULSE | | | | | | | |
| | | 10 kA | 0.5 kA | 1 kA | 1.5 kA | 3 kA | 5 kA | 10 kA | 20 kA |
| 50.5 | 38 | 39 | 39.7 | 41.9 | 43.9 | 47 | 51.5 | 57.5 | |

IEEE C62.11
 STATION CLASS
 ARRESTER

Program Revision
 2021.04.23.04.46.14

REV DATE
01/11/2021

| | | | | | | | |
|---------------------------|-----------|-----------------------|-----|-------------------------------------|------------|--------------|--|
| TITLE | | | | GE ARRESTER 15.3 KV MCOV | | | |
| SIZE | DWG NO. | CAT / PART / ASSY NO. | | REV | | | |
| S | 211512712 | 9L11ZGB018AS | | 1 | | | |
| DO NOT SCALE THIS DRAWING | | DRN BY | NON | DATE | 01/11/2021 | SHEET 1 OF 1 | |