

LINE TERMINAL DETAIL

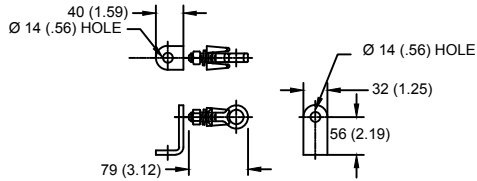

HDG TERMINAL BRACKET, PART No. 896064001
 ONE HDG TERMINAL, PART No. 2714143001
 SUITABLE FOR COPPER OR ALUMINUM CONDUCTOR SIZE
 Ø 7 (.25) - Ø 21 (.81)
 25 - 240 sq mm
 AWG#4 - 500 MCM

GROUND TERMINAL DETAIL

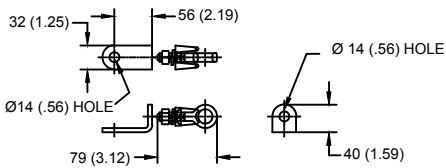

HDG TERMINAL BRACKET, PART No. 896064001
 ONE HDG TERMINAL, PART No. 2714143001
 SUITABLE FOR COPPER OR ALUMINUM CONDUCTOR SIZE
 Ø 7 (.25) - Ø 21 (.81)
 25 - 240 sq mm
 AWG#4 - 500 MCM

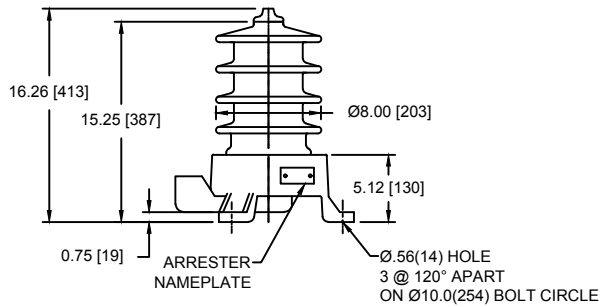

Ø = DIAMETER
 HDG = HOT DIP GALVANIZED

CHARACTERISTICS	
RATED VOLTAGE	24 kVrms
MCOV	19.5 kVrms
MASS	25kg (55lb)
CREEPAGE DISTANCE	508 (20.0)
LIGHTNING IMP W/S	150 kV
SWITCHING IMP W/S	120 kV
POWER FREQ W/S	60 kVrms
TOV 1s	28.7 kVrms
TOV 10s	27.6 kVrms
COG ABOVE BASE	215 (8.5)
HOUSING	GREY PORCELAIN
CANTILEVER FORCE	
MAXIMUM CONTINUOUS	7666 N (1723lbf)
ULTIMATE (UMS)	19164 N (4308lbf)
RECOMMENDED CLEARANCE (TO METAL PARTS)	
PHASE TO GROUND	84 (3.3)
PHASE TO PHASE	67 (2.7)

- NOTES:
 1. DIMENSIONS IN millimeters(inches) SUBJECT TO ±3% TOLERANCE
 2. CLEARANCE AND INSULATION W/S VOLTAGE APPLY AT SEA LEVEL
 3. ARRESTER SUITABLE FOR OPERATION AT ALTITUDES UP TO 4500m (14800ft)

DISCHARGE VOLTAGE (kV) FOR INDICATED IMPULSE TYPES AND CURRENT MAGNITUDES								
FRONT OF WAVE	SWITCHING SURGE	8/20 LIGHTNING IMPULSE						
		10 kA	0.5 kA	1 kA	1.5 kA	3 kA	5 kA	10 kA
63.5	47	49	49.9	52.6	55.1	59	64.6	72.2

IEEE C62.11
 STATION CLASS
 ARRESTER

Program Revision
 2021.04.23.04.46.14

REV DATE
01/11/2021

TITLE GE ARRESTER 19.5 KV MCOV			
SIZE S	DWG NO. 211512708	CAT / PART / ASSY NO. 9L11ZGB024AS	REV 1
DO NOT SCALE THIS DRAWING	DRN BY NON	DATE 01/11/2021	SHEET 1 OF 1