

131kV MCOV

SIZE A	DWG NO 9L11ZTA168AS	SHT 1	REV
REV	DESCRIPTION	DATE	APPROVED

LINE TERMINAL DETAIL

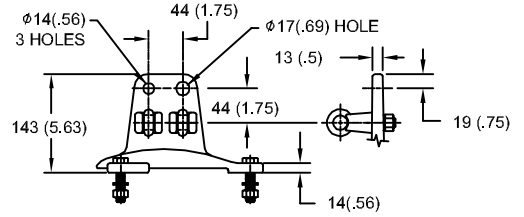

HDG 4-HOLE TERMINAL PAD
TWO HDG TERMINALS
SUITABLE FOR CU OR AL CONDUCTOR SIZE
φ 7 (.25) - φ 21 (.81) DIA
25 - 240 sq mm
AWG#4 - 500 MCM

GROUND TERMINAL DETAIL

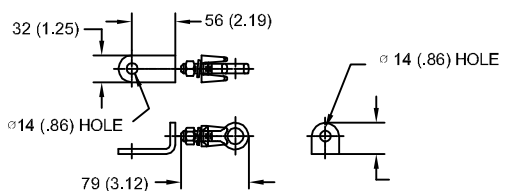

HDG TERMINAL BRACKET
ONE HDG TERMINAL
SUITABLE FOR CU OR AL CONDUCTOR SIZE
φ 7 (.25) - φ 21 (.81) DIA
25 - 240 sq mm
AWG#4 - 500 MCM

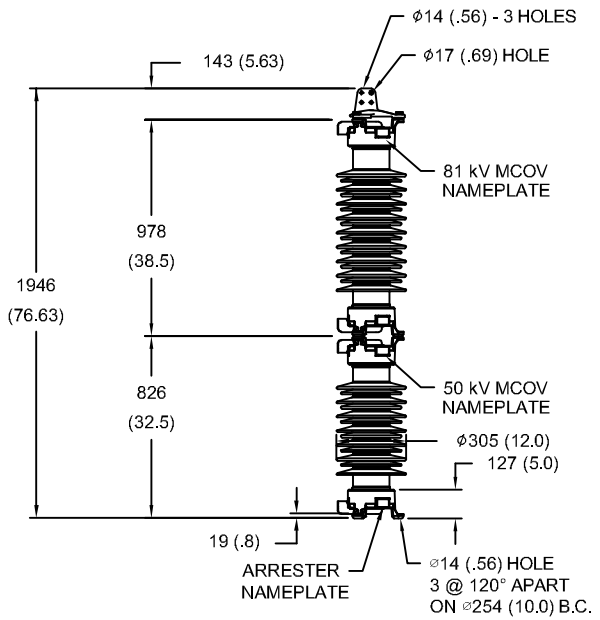

CHARACTERISTICS	
RATED VOLTAGE	168 kVrms
MCOV	131 kVrms
MASS	178kg (391lb)
CREEPAGE DISTANCE	4445 (175.0)
LIGHTNING IMP W/S	742 kV
SWITCHING IMP W/S	640 kV
POWER FREQ W/S	384 kVrms
TOV 1s	195 kVrms
TOV 10s	186 kVrms
COG ABOVE BASE	940 (37.0)
HOUSING	GREY PORCELAIN

CANTILEVER FORCE	
MAXIMUM CONTINUOUS	3494 N (785lbf)
ULTIMATE (UMS)	8734 N (1963lbf)

RECOMMENDED CLEARANCE (TO METAL PARTS)	
PHASE TO GROUND	739 (29.1)
PHASE TO PHASE	850 (33.5)

NOTES:
1. DIMENSIONS IN millimeters(inches) SUBJECT TO ±3% TOLERANCE
2. CLEARANCE AND INSULATION W/S VOLTAGE APPLY AT SEA LEVEL
3. ARRESTER SUITABLE FOR OPERATION AT ALTITUDES UP TO 3650m (12000ft)

DISCHARGE VOLTAGE (kV) FOR INDICATED IMPULSE TYPES AND CURRENT MAGNITUDES							
FRONT OF WAVE	SWITCHING SURGE	8/20 LIGHTNING IMPULSE					
		1.5 kA	3 kA	5 kA	10 kA	20 kA	40 kA
10 kA	1 kA	337	350	362	380	406	447
412	322						

GE ENERGY FORT EDWARD, N.Y., U.S.A.	SIZE A	ANSI STATION CLASS	ARRESTER 9L11ZTA168AS	SHEET 1	CONT ON -
	DRAWN JBC				
ISSUED	DATE 04/14/2011				

DISTR. TO