

SIZE A	DWG NO 9L11ZTA192ASB	SHT 1	REV 1
REV 1	DESCRIPTION UPDATE	DATE 9/20/2013	APPROVED JBC

152kV MCOV

LINE TERMINAL DETAIL

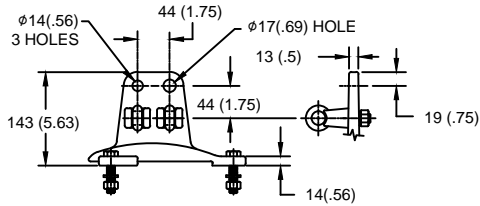

HDG 4-HOLE TERMINAL PAD
TWO TIN-PLATED TERMINALS
SUITABLE FOR CU OR AL CONDUCTOR SIZE
φ 11 (.42) - φ 29 (1.15) DIA
70 - 500 sq mm
2/0 - 1000 MCM

GROUND TERMINAL DETAIL

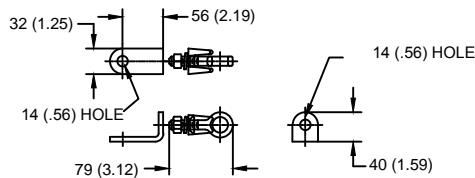

HDG TERMINAL BRACKET
ONE TIN-PLATED TERMINAL
SUITABLE FOR Cu OR Al CONDUCTOR SIZE
φ 11 (.42) - φ 29 (1.15)
70 - 500 sq mm
2/0 - 1000 MCM

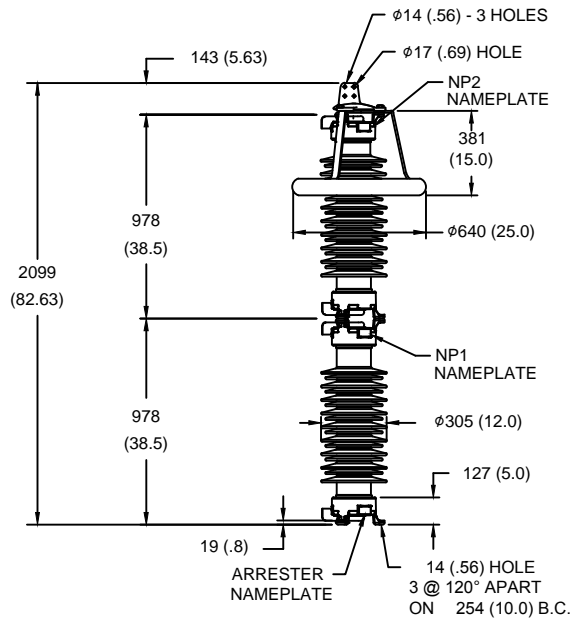

CHARACTERISTICS

RATED VOLTAGE	192 kVrms
MCOV	152 kVrms
MASS	203kg (446lb)
CREEPAGE DISTANCE	5080 (200.0)
LIGHTNING IMP W/S	872 kV
SWITCHING IMP W/S	776 kV
POWER FREQ W/S	432 kVrms
TOV 1s	226 kVrms
TOV 10s	216 kVrms
COG ABOVE BASE	1039 (40.9)
HOUSING	GREY PORCELAIN

CANTILEVER FORCE

MAXIMUM CONTINUOUS	3240 N (728lbf)
ULTIMATE (UMS)	8100 N (1821lbf)

RECOMMENDED CLEARANCE (TO METAL PARTS)

PHASE TO GROUND	864 (34.0)
PHASE TO PHASE	991 (39.0)

NOTES:
1. DIMENSIONS IN millimeters(inches) SUBJECT TO ±3% TOLERANCE
2. CLEARANCE AND INSULATION W/S VOLTAGE APPLY AT SEA LEVEL
3. ARRESTER SUITABLE FOR OPERATION AT ALTITUDES UP TO 3650m (12000ft)

DISCHARGE VOLTAGE (kV) FOR INDICATED IMPULSE TYPES AND CURRENT MAGNITUDES

FRONT OF WAVE	SWITCHING SURGE	8/20 LIGHTNING IMPULSE					
		1.5 kA	3 kA	5 kA	10 kA	20 kA	40 kA
10 kA	1 kA	391	406	420	441	471	518
479	374						



GE ENERGY
FORT EDWARD, N.Y., U.S.A.

SIZE
A

ANSI
STATION CLASS

ARRESTER
9L11ZTA192ASB

DRAWN JBC DATE 04/14/2011

ISSUED DATE 04/14/2011

SCALE

SHEET 1 CONT ON -

DISTR. TO