

180kV MCOV

SIZE A	DWG NO 9L11ZTA228AS	SHT 1	REV
REV	DESCRIPTION	DATE	APPROVED

LINE TERMINAL DETAIL

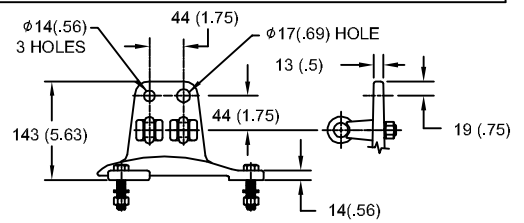

HDG 4-HOLE TERMINAL PAD
 TWO HDG TERMINALS
 SUITABLE FOR CU OR AL CONDUCTOR SIZE
 φ 7 (.25) - φ 21 (.81) DIA
 25 - 240 sq mm
 AWG#4 - 500 MCM

GROUND TERMINAL DETAIL

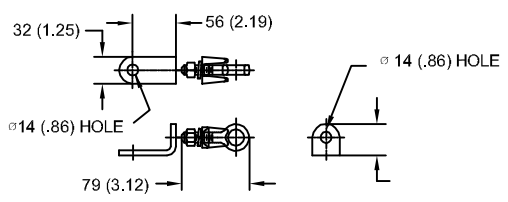

HDG TERMINAL BRACKET
 ONE HDG TERMINAL
 SUITABLE FOR CU OR AL CONDUCTOR SIZE
 φ 7 (.25) - φ 21 (.81) DIA
 25 - 240 sq mm
 AWG#4 - 500 MCM

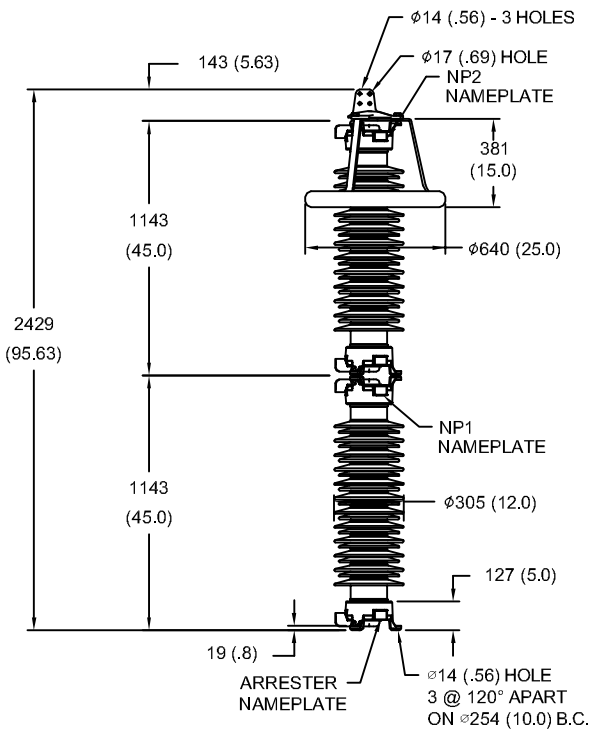

CHARACTERISTICS

RATED VOLTAGE	228 kVrms
MCOV	180 kVrms
MASS	238kg (523lb)
CREEPAGE DISTANCE	6414 (252.5)
LIGHTNING IMP W/S	944 kV
SWITCHING IMP W/S	796 kV
POWER FREQ W/S	477 kVrms
TOV 1s	268 kVrms
TOV 10s	256 kVrms
COG ABOVE BASE	1215 (47.8)
HOUSING	GREY PORCELAIN

CANTILEVER FORCE

MAXIMUM CONTINUOUS	2800 N (629lbf)
ULTIMATE (UMS)	6999 N (1573lbf)

RECOMMENDED CLEARANCE (TO METAL PARTS)

PHASE TO GROUND	1029 (40.5)
PHASE TO PHASE	1177 (46.4)

- NOTES:
 1. DIMENSIONS IN millimeters(inches) SUBJECT TO ±3% TOLERANCE
 2. CLEARANCE AND INSULATION W/S VOLTAGE APPLY AT SEA LEVEL
 3. ARRESTER SUITABLE FOR OPERATION AT ALTITUDES UP TO 3650m (12000ft)

DISCHARGE VOLTAGE (kV) FOR INDICATED IMPULSE TYPES AND CURRENT MAGNITUDES							
FRONT OF WAVE	SWITCHING SURGE	8/20 LIGHTNING IMPULSE					
		1.5 kA	3 kA	5 kA	10 kA	20 kA	40 kA
10 kA	1 kA	462	481	497	522	557	613
566	443						

GE ENERGY FORT EDWARD, N.Y., U.S.A.	SIZE A	ANSI STATION CLASS	ARRESTER 9L11ZTA228AS	SHEET 1	CONT ON -
	DRAWN JBC				
ISSUED	DATE 04/14/2011	SCALE			

DISTR. TO