

# 235kV MCOV

SIZE A	DWG NO 9L11ZTA294AS	SHT 1	REV
REV	DESCRIPTION	DATE	APPROVED

### LINE TERMINAL DETAIL

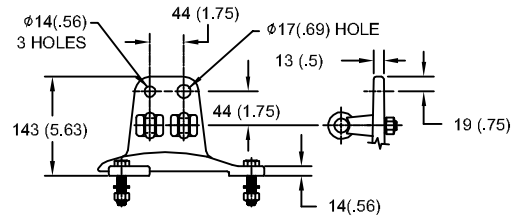

HDG 4-HOLE TERMINAL PAD  
 TWO HDG TERMINALS  
 SUITABLE FOR CU OR AL CONDUCTOR SIZE  
 φ 7 (.25) - φ 21 (.81) DIA  
 25 - 240 sq mm  
 AWG#4 - 500 MCM

### GROUND TERMINAL DETAIL

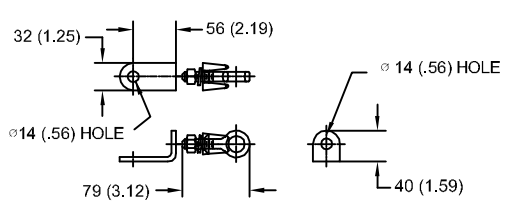

HDG TERMINAL BRACKET  
 ONE HDG TERMINAL  
 SUITABLE FOR CU OR AL CONDUCTOR SIZE  
 φ 7 (.25) - φ 21 (.81) DIA  
 25 - 240 sq mm  
 AWG#4 - 500 MCM

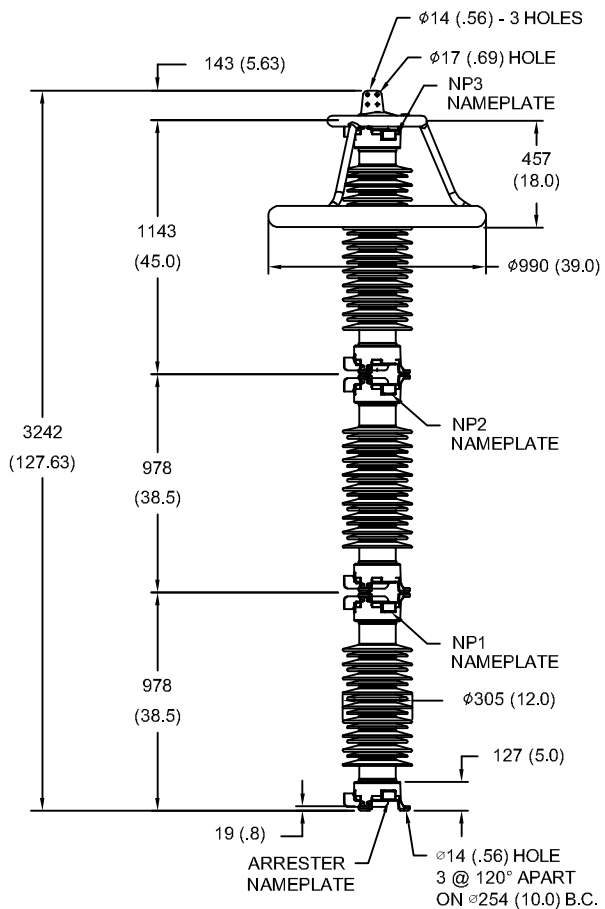

NOTES:  
 1. DIMENSIONS IN millimeters(inches) SUBJECT TO ±3% TOLERANCE  
 2. CLEARANCE AND INSULATION W/S VOLTAGE APPLY AT SEA LEVEL  
 3. ARRESTER SUITABLE FOR OPERATION AT ALTITUDES UP TO 3650m (12000ft)

CHARACTERISTICS	
RATED VOLTAGE	294 kVrms
MCOV	235 kVrms
MASS	317kg (698lb)
CREEPAGE DISTANCE	8287 (326.3)
LIGHTNING IMP W/S	1384 kV
SWITCHING IMP W/S	1218 kV
POWER FREQ W/S	732 kVrms
TOV 1s	350 kVrms
TOV 10s	334 kVrms
COG ABOVE BASE	1647 (64.8)
HOUSING	GREY PORCELAIN

CANTILEVER FORCE	
MAXIMUM CONTINUOUS	2098 N (472lbf)
ULTIMATE (UMS)	5244 N (1179lbf)

RECOMMENDED CLEARANCE (TO METAL PARTS)	
PHASE TO GROUND	1356 (53.4)
PHASE TO PHASE	1547 (60.9)

DISCHARGE VOLTAGE (kV) FOR INDICATED IMPULSE TYPES AND CURRENT MAGNITUDES							
FRONT OF WAVE	SWITCHING SURGE	8/20 LIGHTNING IMPULSE					
		1.5 kA	3 kA	5 kA	10 kA	20 kA	40 kA
10 kA	2 kA	603	627	649	681	727	800
739	598						

GE ENERGY FORT EDWARD, N.Y., U.S.A.	SIZE <b>A</b>	ANSI STATION CLASS	<h2>ARRESTER</h2> <h2>9L11ZTA294AS</h2>	SHEET 1	CONT ON -
	DRAWN JBC DATE 04/14/2011				
ISSUED DATE 04/14/2011					