

245kV MCOV

SIZE A	DWG NO 9L11ZTA312AS	SHT 1	REV
REV	DESCRIPTION	DATE	APPROVED

LINE TERMINAL DETAIL

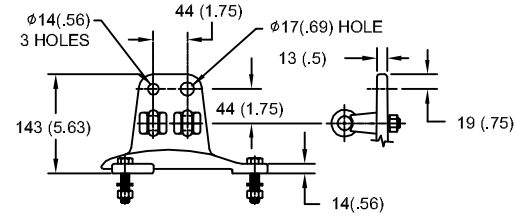

HDG 4-HOLE TERMINAL PAD
TWO HDG TERMINALS
SUITABLE FOR CU OR AL CONDUCTOR SIZE
Ø 7 (.25) - Ø 21 (.81) DIA
25 - 240 sq mm
AWG#4 - 500 MCM

GROUND TERMINAL DETAIL

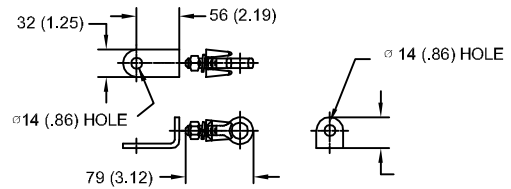

HDG TERMINAL BRACKET
ONE HDG TERMINAL
SUITABLE FOR CU OR AL CONDUCTOR SIZE
Ø 7 (.25) - Ø 21 (.81) DIA
25 - 240 sq mm
AWG#4 - 500 MCM

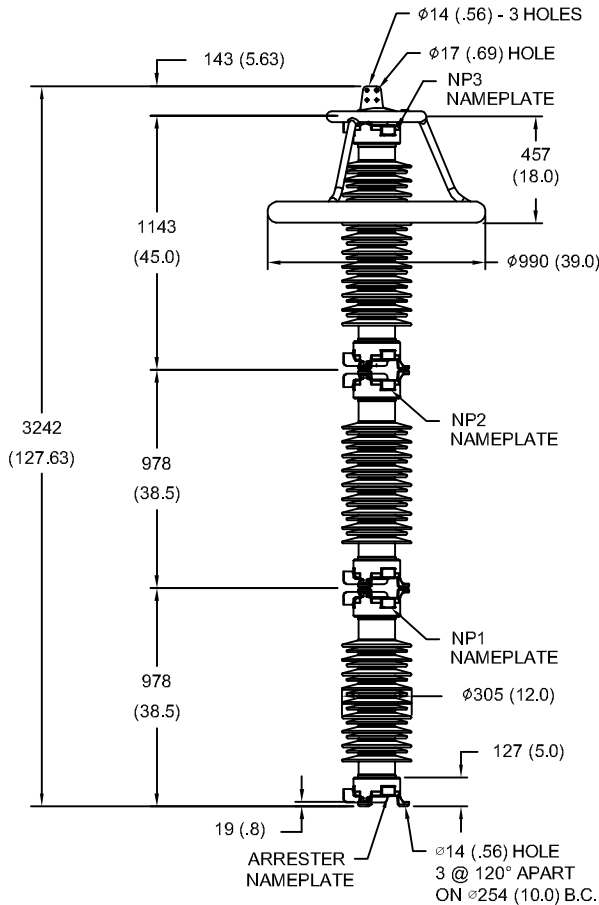

- NOTES:
1. DIMENSIONS IN millimeters(inches) SUBJECT TO ±3% TOLERANCE
2. CLEARANCE AND INSULATION W/S VOLTAGE APPLY AT SEA LEVEL
3. ARRESTER SUITABLE FOR OPERATION AT ALTITUDES UP TO 3650m (12000ft)

CHARACTERISTICS	
RATED VOLTAGE	312 kVrms
MCOV	245 kVrms
MASS	320kg (703lb)
CREEPAGE DISTANCE	8287 (326.3)
LIGHTNING IMP W/S	1288 kV
SWITCHING IMP W/S	1029 kV
POWER FREQ W/S	618 kVrms
TOV 1s	365 kVrms
TOV 10s	349 kVrms
COG ABOVE BASE	1645 (64.8)
HOUSING	GREY PORCELAIN

CANTILEVER FORCE	
MAXIMUM CONTINUOUS	2098 N (472lbf)
ULTIMATE (UMS)	5244 N (1179lbf)

RECOMMENDED CLEARANCE (TO METAL PARTS)	
PHASE TO GROUND	1416 (55.7)
PHASE TO PHASE	1614 (63.5)

DISCHARGE VOLTAGE (kV) FOR INDICATED IMPULSE TYPES AND CURRENT MAGNITUDES							
FRONT OF WAVE	SWITCHING SURGE	8/20 LIGHTNING IMPULSE					
20 kA	2 kA	1.5 kA	3 kA	5 kA	10 kA	20 kA	40 kA
853	623	629	654	676	710	758	834



GE ENERGY
FORT EDWARD, N.Y., U.S.A.

SIZE

A

ANSI
STATION CLASS

ARRESTER
9L11ZTA312AS

DRAWN JBC DATE 04/14/2011

ISSUED DATE 04/14/2011

SCALE

SHEET 1 CONT ON -

DISTR. TO