

SIZE A	DWG NO 911ZTA360AS	SHT 1	REV 1
REV 1	DESCRIPTION Update	DATE 9/20/13	APPROVED JBC

# 288 kV MCOV

## LINE TERMINAL DETAIL

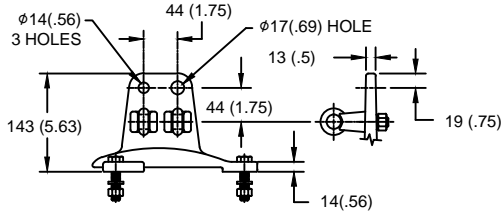

HDG 4-HOLE TERMINAL PAD  
TWO HDG TERMINALS  
SUITABLE FOR CU OR AL CONDUCTOR SIZE  
φ 7 (.25) - φ 21 (.81) DIA  
25 - 240 sq mm  
AWG#4 - 500 MCM

## GROUND TERMINAL DETAIL

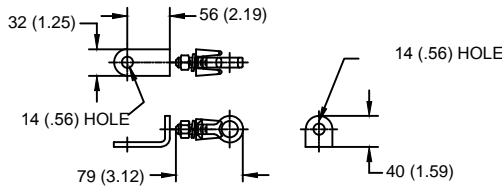

HDG TERMINAL BRACKET  
ONE HDG TERMINAL  
SUITABLE FOR CU OR AL CONDUCTOR SIZE  
φ 7 (.25) - φ 21 (.81) DIA  
25 - 240 sq mm  
AWG#4 - 500 MCM

## CHARACTERISTICS

RATED VOLTAGE	360 kVrms
MCOV	288 kVrms
MASS	358kg (788lb)
CREEPAGE DISTANCE	9621 (378.8)
LIGHTNING IMP W/S	1536 kV
SWITCHING IMP W/S	1326 kV
POWER FREQ W/S	900 kVrms
TOV 1s	429 kVrms
TOV 10s	410 kVrms
COG ABOVE BASE	1790 (70.5)
HOUSING	GREY PORCELAIN

## CANTILEVER FORCE

MAXIMUM CONTINUOUS	1904 N (428lbf)
ULTIMATE (UMS)	4759 N (1070lbf)

## RECOMMENDED CLEARANCE (TO METAL PARTS)

PHASE TO GROUND	1671 (65.8)
PHASE TO PHASE	1903 (76.9)

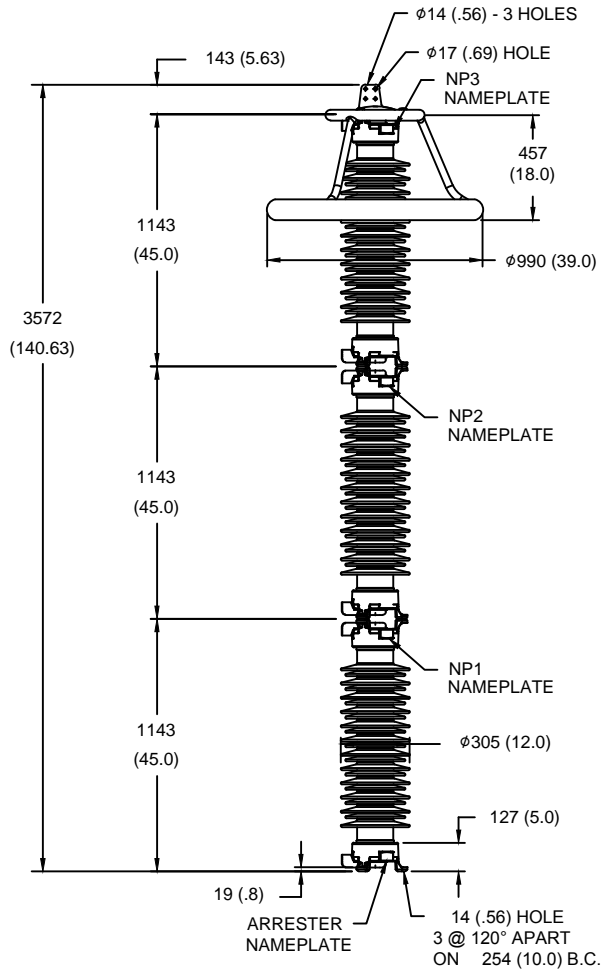

### NOTES:

1. DIMENSIONS IN millimeters(inches) SUBJECT TO ±3% TOLERANCE
2. CLEARANCE AND INSULATION W/S VOLTAGE APPLY AT SEA LEVEL
3. ARRESTER SUITABLE FOR OPERATION AT ALTITUDES UP TO 3650m (12000ft)

## DISCHARGE VOLTAGE (kV) FOR INDICATED IMPULSE TYPES AND CURRENT MAGNITUDES

FRONT OF WAVE	SWITCHING SURGE	8/20 LIGHTNING IMPULSE					
		1.5 kA	3 kA	5 kA	10 kA	20 kA	40 kA
10 kA	2 kA	739	769	795	835	891	981
906	733						



GE ENERGY  
FORT EDWARD, N.Y., U.S.A.

SIZE  
**A**

ANSI  
STATION CLASS

**ARRESTER**  
**9L11ZTA360AS**

DRAWN JBC DATE 4/11/14

ISSUED DATE 4/11/14

SCALE

SHEET 1 CONT ON -

DISTR. TO