

SIZE A	DWG NO 9L15GCA001	SHT 1	REV
REV	DESCRIPTION	DATE	APPROVED

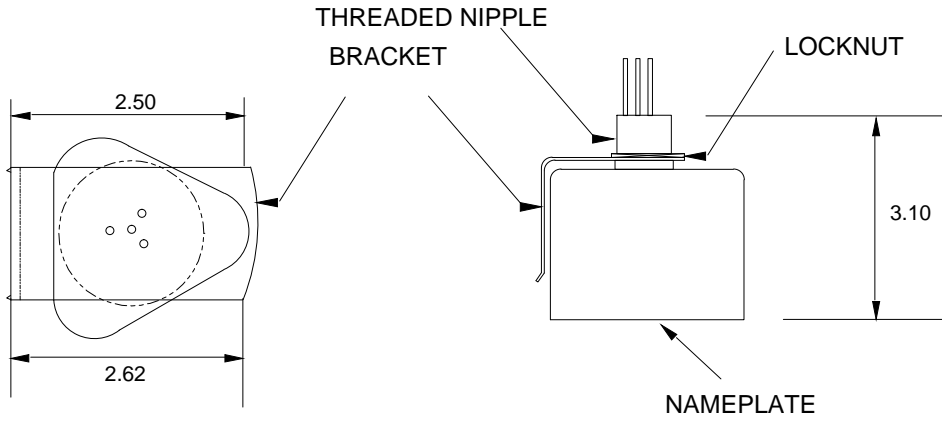

SINGLE PHASE - TWO WIRE
VOLTAGE - 120, 480, TO 650 MAX

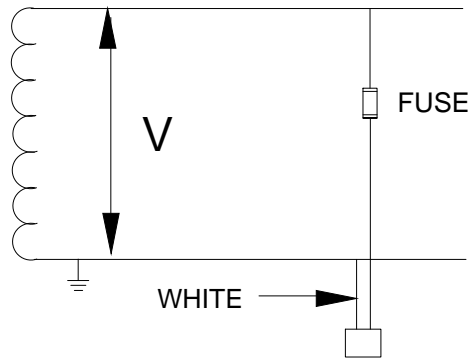

GE ENERGY
FORT EDWARD, N.Y., U.S.A.

SIZE
A

9L15GCA001
SURGE PROTECTIVE DEVICE

DRAWN D SEYMOUR DATE 3/11/2016

ISSUED DATE 3/11/2016

SCALE

SHEET 1 CONT ON -

DISTR. TO