

SIZE A	DWG NO 9L15GCB001	SHT 1	REV
REV	DESCRIPTION	DATE	APPROVED

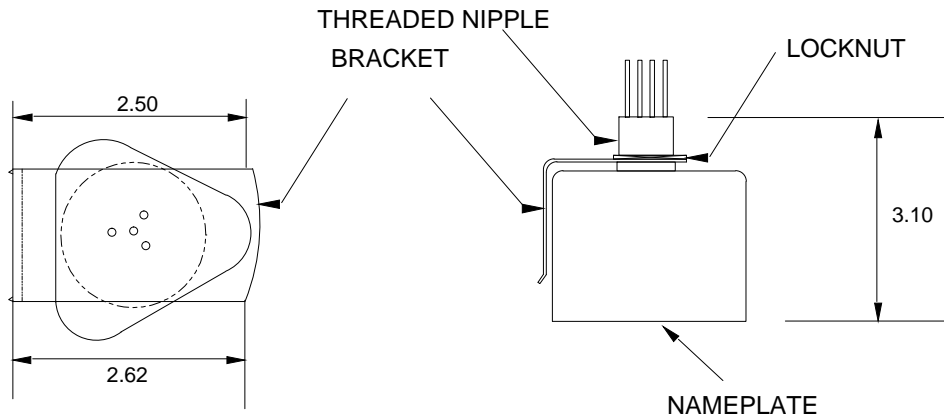

SINGLE PHASE - THREE WIRE

VOLTAGE - 240, 480, TO 1300 MAX

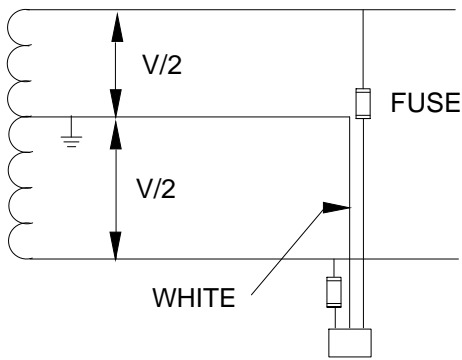

THREE PHASE - DELTA

ONE PHASE - GROUNDING

VOLTAGE - 240, 480, TO 650 MAX

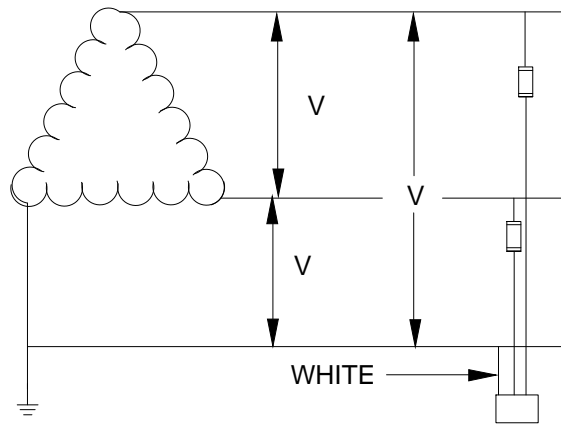

GE ENERGY  
FORT EDWARD, N.Y., U.S.A.

SIZE  
**A**

**9L15GCB001**

**SURGE PROTECTIVE DEVICE**

DRAWN D SEYMOUR DATE 3/11/2016

ISSUED DATE 3/11/2016

SCALE

SHEET 1 CONT ON -

DISTR. TO