

Characteristics:

Standard	ANSI C29.9 ANSI C29.1
Leadage Distance inches(mm)	165(4192)
Cantilever Strength pounds(kN)	1450(6.45)
Tensile Strength pounds(kN)	25000(111.3)
Torsional Strength inch-pounds(kNm)	90000(10.2)
Compression Strength pounds(kN)	75000(333.8)
Voltage Class (kV)	200
Impulse Flashover ,Positive kV	1010
Low Frequency Withstand,10sec Wet, kV	385
Impulse Withstand kV	900
Test Voltage,Rms to Ground (kV) Maximum RIV,Microvolts at 1000kHz	146 500
Net weight Pound/kg	≈381(173)
Flange material	Nordlar case iron
Glazed color	ANSI 70 GRAY

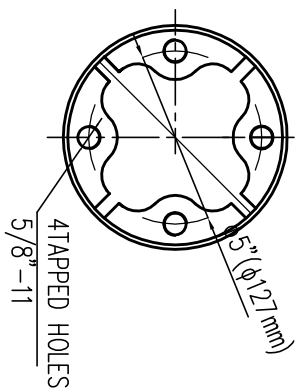

AB direction

All flanges are hot dip galvanized.

Revd	5/16/2008	By	Date	Standard Drawing	Xian XD High Voltage Porcelain Insulator Co. Ltd.
Designed					TR308 Solid-Core Post Insulator
Checked					2982 (V)
Approved					

